

**How to set up
your sunshade
deluxe**

2 Place the centre of the sunshade on the boom with the straps on both railing sides.

3 Pull the sunshade to the back until the opening is at the end of the boom. Close the opening with the velcro strip.

4 Close the buckle to secure the closure.

5 Position the back of the sunshade with the rope.

6 Fix the front side of the sunshade with the large strap around the mast. Close the strap with the buckle.

7 And with the small strap around the boom. Close the strap with the buckle.

8 Tighten the straps. Use the rubber band to keep the strap ends together.

9 Assemble the battens.

10 Put the battens in the sunshade pockets from port to starboard.

11 Pull elastic strap and fix batten in small pocket.

12 Close strap with pull tab.

13 Connect the straps to the railing on both sides to position the sunshade. Start with the luf side from front to back. Adjust the straps.

1

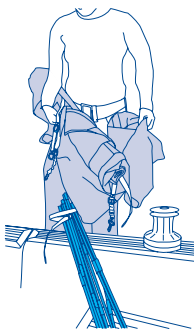

2

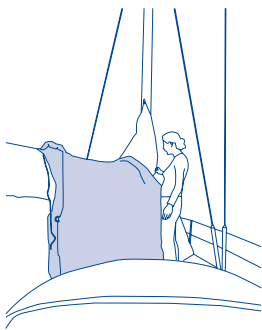

3

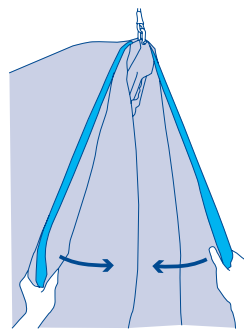

4

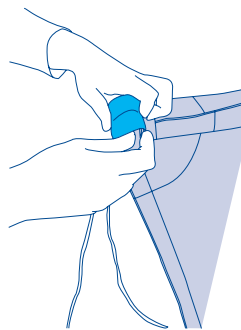

5

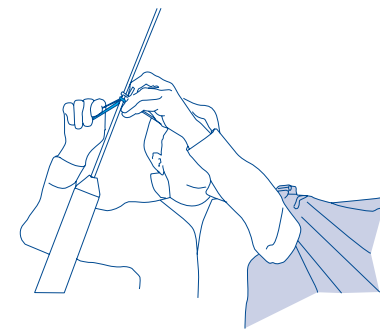

6

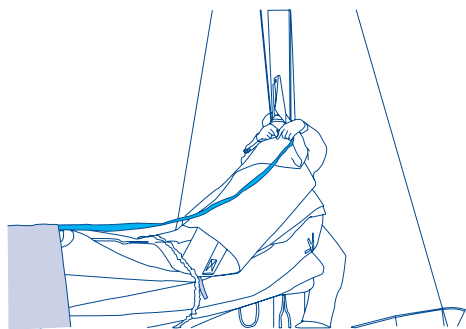

7

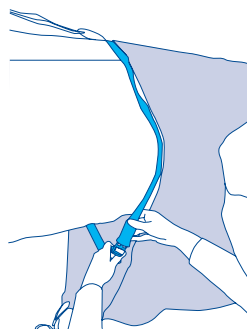

8

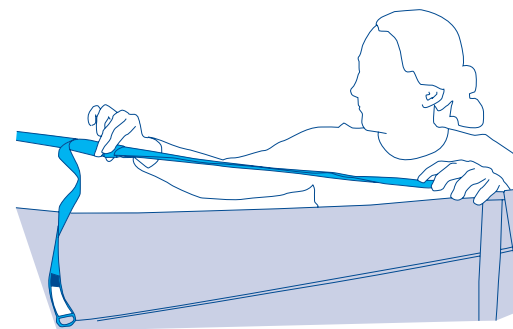

9

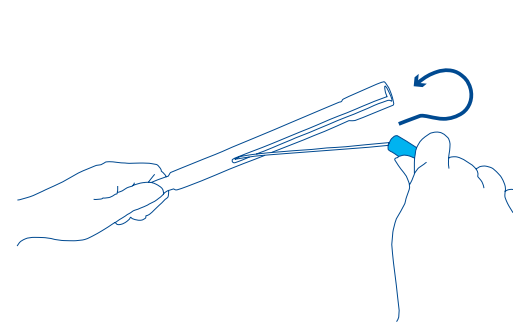

10

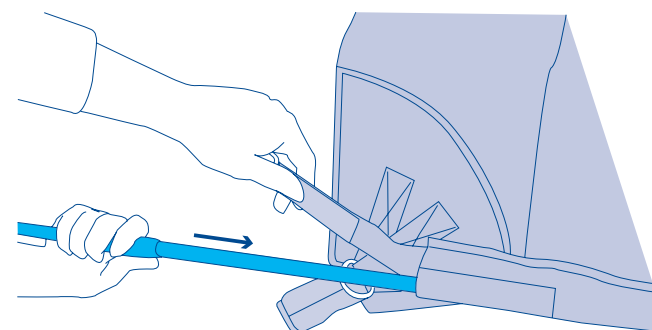

11

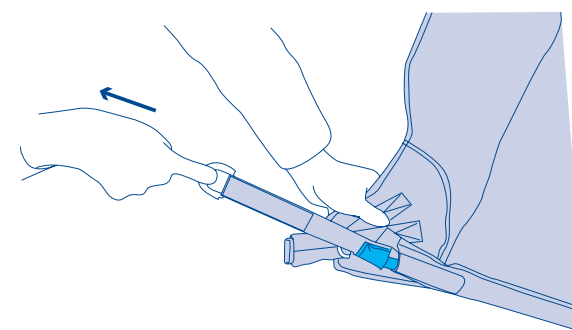

12

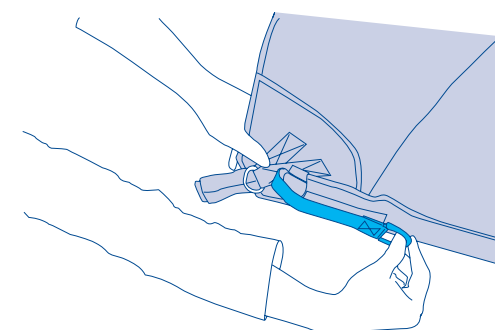

13

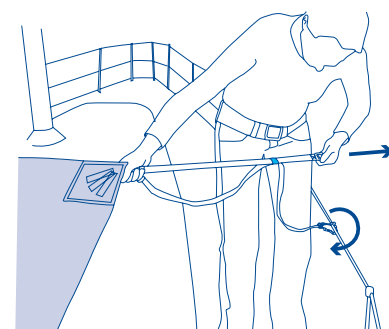

14

